

**WALL NOTES**

**WALL CODE:** Refer GA plans

**WB** ← Wall Cladding Type

**STANDARD HOUSE TYPES WALL CLADDING LEGEND**

(COVERS ALL REGIONAL HOUSE TYPES WITHIN STANDADISED PLAN SUITE - NOT ALL CLADDING TYPES APPEAR ON ALL DESIGNS)

**WB** Horizontal Weatherboards on 20mm cavity on breathable underlay or RAB. Site-architect to select either H3.1 treated timber (A4501-A4549) or fibre-cement-painted (A4551-A4599)

**BRK** 70mm wide clay brick veneer (max 140 kg/m<sup>2</sup>) on minimum 50mm clear cavity on breathable underlay or Rigid Air Barrier.

**CASE SECTION**

Site Architect to determine appropriate structural case for location. Refer to Structural Engineer's Documentation for requirements.

**BRACING**

Refer to Structural Engineers drawings for bracing requirements. When plywood is required on external walls then line entire wall with ply.

**WALL INTERNAL LININGS**

Internal non-wet areas to be lined with 10mm standard plasterboard unless otherwise noted. Refer SED drawings for bracing requirements.

Internal bathroom/toilet walls to be lined with either 10mm water resistant plasterboard unless noted, or 4.5mm white gloss glazed smooth lining on battens over 17mm H3.2 CCA treated plywood. (Refer to 5700 series for locations.)

Provide splashbacks to bath and vanity (300mm high) and shower (2400mm high).

Level 4 finish throughout - refer to specification for paint finish to all internal walls

**INSULATION**

Semi rigid friction fitted R2.0 min. polyester wall insulation to all external walls.

**CEILING LEGEND**

**(S)** Ceiling mounted Type 1 domestic smoke alarms with test and hush buttons to comply with NZ Building Code Section F7 C1 3.2

**(ME)** Mechanical Ventilation - refer Mechanical Documentation

**CEILING LINING NOTES**

13mm plasterboard to internal non-wet areas. 13mm water resistant plasterboard to wet-areas.

Level 4 finish throughout to receive paint finish. Linings fixed over proprietary or timber battens at 600c/s to manufacturers requirements.

**INDICATIVE SLOT DRAINS**

Location adjacent to slab. Extents and connections to be developed by Site Architect/ Contractor based on site conditions.

ROOM I.D	ROOM NAME	FLOOR FINISH
O.01	KDL	VINYL & CARPET
O.02	HALL	CARPET
O.03	CUP'D 1	N/A
O.04	CUP'D 2	CARPET
O.05	BED	CARPET
O.06	WRDB 1	CARPET
O.07	ACC BATH	VINYL
O.08	ACC BED	CARPET
O.09	WRDB 2	CARPET

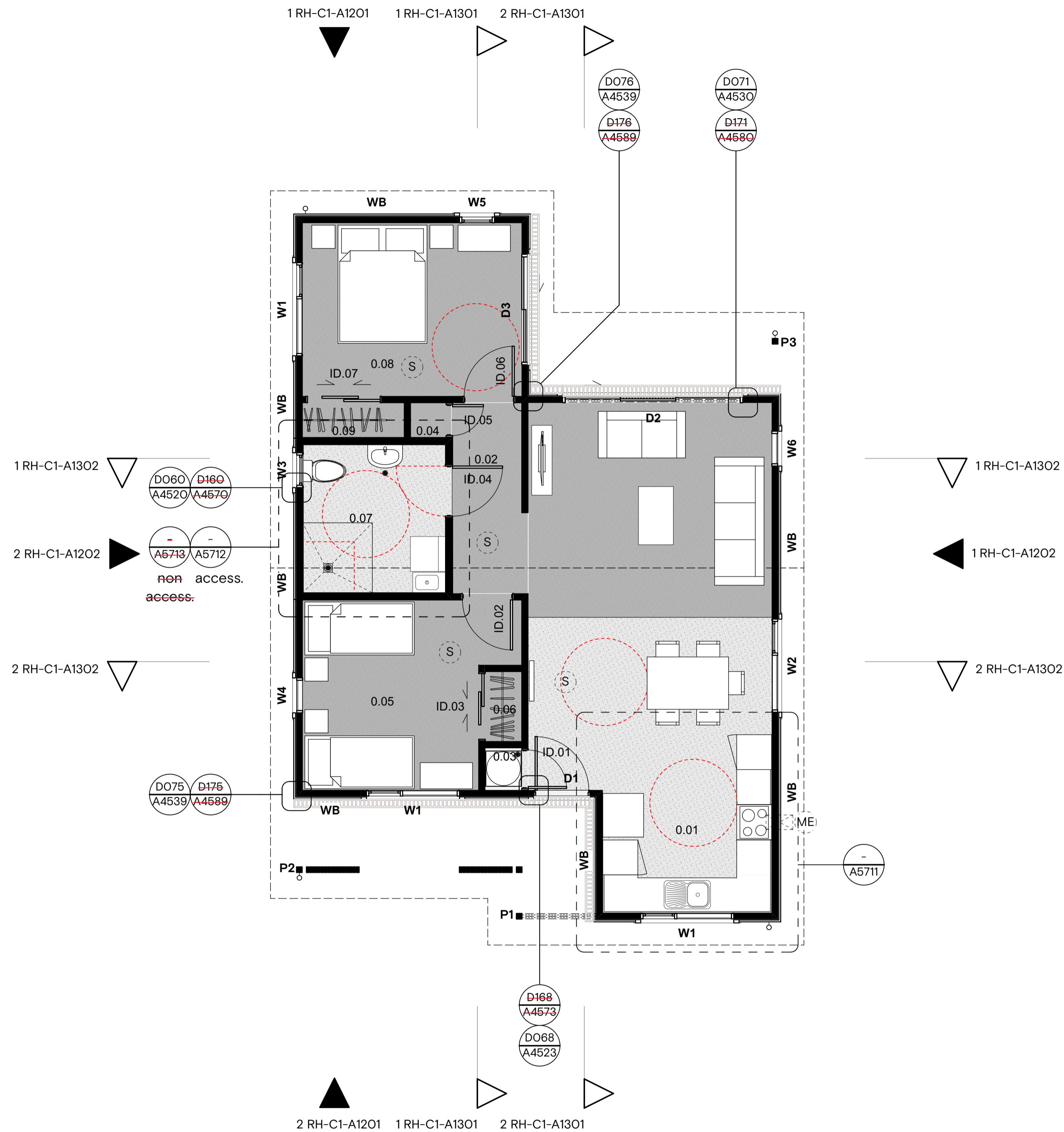

**GENERAL NOTES**

These drawings have been prepared for the purposes of Multiproof Approval. The Contractor is to refer to the relevant Multiproof Certificate, which shall be read in conjunction with the drawings and other documents listed therein.

For Multiproof scope and code compliance notes refer to sheet A1002, the limitations for the application of Multiproof Approvals to site conditions are tabulated on sheet A1003.

Site Architects shall be responsible for the design of site specific integration and services connections and NZBC Code compliance where outside of the Multiproof Scope.

Material selections by Site Architect/ Contractor in accordance with the Specifications to HN2C approval shall meet NZBC B2 requirements, relevant NZ Standards and/or BRANZ recommendations, including providing Operations & Maintenance Manuals.

Deviation from Multiproof approved details & documentation to be approved by HN2C and MBIE/Building Consent Authority.

Multiproof Approval does not relieve the contractor from obtaining Building Consent from the relevant Building Consenting Authority prior to commencing construction.

**ORIENTATIONS**

These designs have been prepared to suit a range of orientations, with north-facing types available to suit site configurations where the standard type does not meet HN2C design objectives. Stated elevation orientations shown in this Multiproof Approval represent the optimal orientations.

The Contractor shall verify with the Site Architect the proposed site orientation and that the appropriate typology is used as per HN2C briefing requirements.

Rev	Date	Notes
O1	07/06/19	For Approval
F	23/03/19	For Approval
E	26/03/19	For Approval
D	14/02/19	For Approval
C	13/07/18	For Information
B	06/07/18	For Information

**Do not scale.**  
The contractor shall verify all dimensions before commencing work, and all discrepancies to be referred to Context Architects Limited for clarification. These plans are confidential and are not to be discussed or copied without the express permission of Context Architects Limited.



Project  
**HN2C Regional Housing Programme**

Client  
**HN2C**



Consultants  
Structural Engineer **Kirk Roberts**  
Services Engineer **22 Degrees Ltd**  
Acoustic Engineer **Earon Acoustics Ltd**  
Framing Consultant **Buildable Layouts Ltd**

Title  
**Ground Floor GA Plan**

Issued For  
**For Approval**

Scale  
**1:50 @ A1**  
**1:100 @ A3**

Project no. Drawing no. Rev.  
**17185 RH-C1-A1101 01**